

MASTER SIGHT PUSHER[®]

PRECISION ENGINEERED SIGHT CHANGER

USER MANUAL



INSTRUCTIONS OVERVIEW

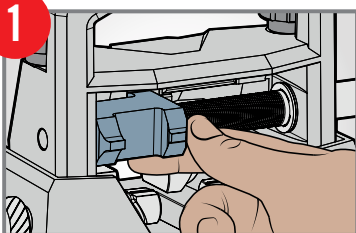

1 Select applicable Reversible Press Block face and return block to center of Magnum Push Rod.

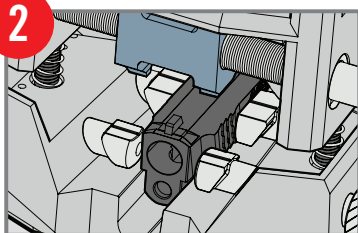

2 Align Slide Clamp guidelines with center of dovetail slot and secure slide in Slide Cradle.

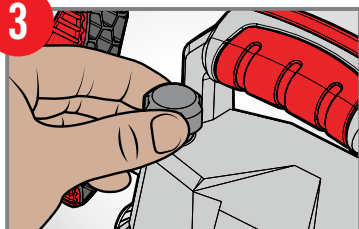

3 Lower Reversible Press Block to the appropriate height.

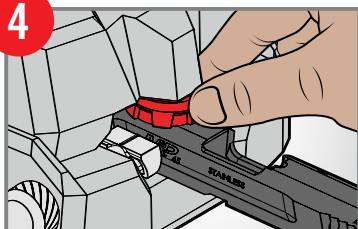

4 Snugly tighten Vertical Stabilizer to hold pistol slide in place.

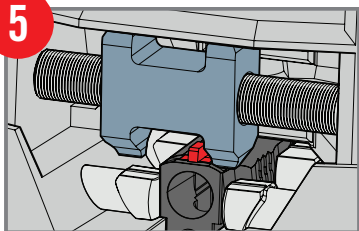

5 Confirm alignment with Reversible Press Block and sight.

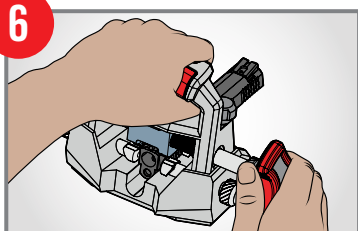

6 Turn Easy Torque Handle™ and push sight through dovetail slot.

WARNING: TO AVOID DAMAGE READ USER MANUAL AND REFER TO YOUR GUN MANUAL PRIOR TO USE.



MASTER SIGHT PUSHER®

PRECISION ENGINEERED SIGHT CHANGER

Some press-fit sights require installation and removal from the left or right side only and will vary by manufacturer and model. Before proceeding, confirm this requirement with the manufacturer to avoid sight and slide damage.

WARNING: TO AVOID DAMAGE READ USER MANUAL AND REFER TO YOUR GUN MANUAL PRIOR TO USE.

BEFORE YOU GET STARTED

LUBRICATION: Before each and every use, make sure these locations are well oiled. Lubrication is important to increase efficiency and reduce wear.

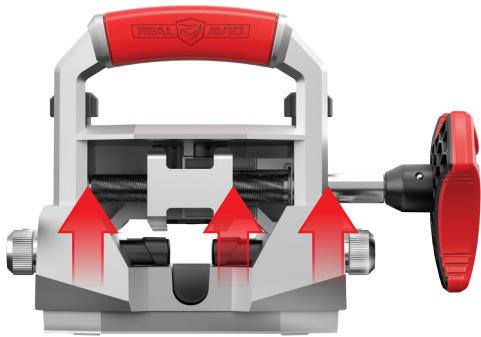

APPLY OIL TO BEARING AND THREAD SURFACES PRIOR TO EACH USE

CHECK COMPATIBILITY OF YOUR SLIDE BY SCANNING CODE

FOR PISTOL COMPATIBILITY, SCAN CODE

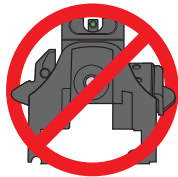

MASTER SIGHT PUSHER IS NOT COMPATIBLE WITH MOST HAMMER-FIRE SLIDES CONTAINING AN EXTERNAL SAFETY

Scan for easy reference. Listed are some popular full-size and sub-compacts that are not compatible due to size.

HOW TO MEASURE YOUR SLIDE.

The Master Sight Pusher® is compatible with most pistol slides. To confirm fitment with your pistol, measure the slide height and width referencing the diagram below. Compact slides may require use of the Expansion Plate.

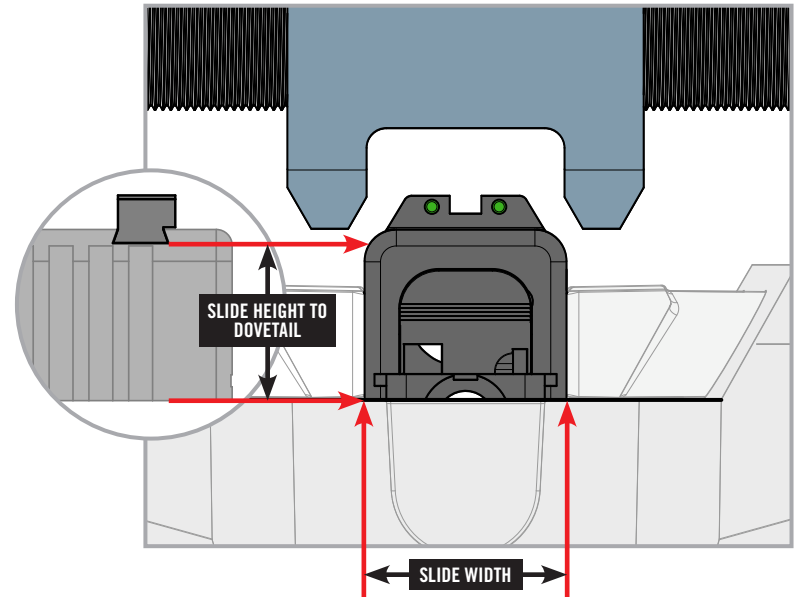

USE OF THE COMPACT SLIDE EXPANSION PLATE IS REQUIRED IF:
Width of slide is 18-23mm AND / OR height to slide dovetail is less than 18mm

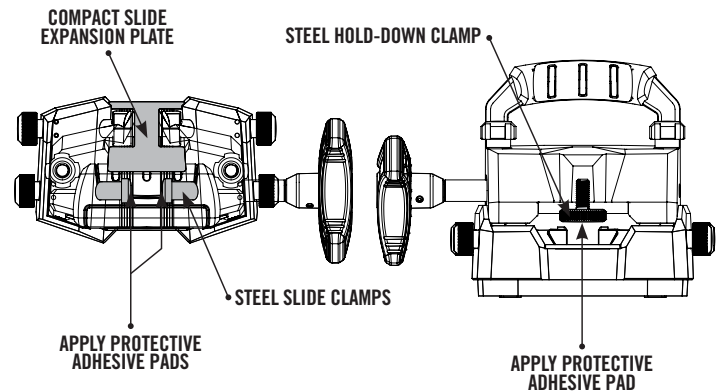

STEEL SLIDE CLAMPS, HOLD-DOWN CLAMP AND PROTECTIVE ADHESIVE PADS.

For additional capability, we have included a steel clamp set. These high strength components expand the capabilities of the Master Sight Pusher, but they also increase the potential for causing damage to your slide. We recommend starting with the plastic clamp set before moving onto the steel set if necessary. Make sure to apply fresh Protective Adhesive Pads to the metal clamps to reduce the risk of scratches, but note: slide damage is still possible. When installing a tight-fitting sight, consider improving the fit of the sight by filing the edges of the new sight. Sights that have been factory-installed with hydraulic presses are often damaged during the removal process and are best suited to be cut or hammered out. Do not apply force in excess of 150 inch-lbs to the Easy Torque Handle™.

GUN SAFETY IS A PRIORITY. Before working on any firearm, make sure the gun is unloaded, the chamber is empty and the gun is pointed in a safe direction.

CHANGE YOUR SIGHT – DO IT YOURSELF. INSTALL PRESS-FIT SIGHTS IN 6 EASY STEPS.

1 SELECT APPLICABLE PRESS BLOCK FACE AND RETURN BLOCK TO CENTER OF PUSH ROD.

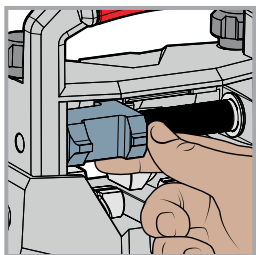

Select appropriate Reversible Press Block orientation. If you would like to use the opposite surface on the Press Block, rotate the Easy Torque Handle™ clockwise to transport the Press Block all the way to the left. At this point, the Press Block should rotate freely without the support wall behind it. With the correct side selected, return the Press Block to the center by rotating the Easy Torque Handle counter-clockwise.

Reversible Press Block provides multiple pushing surfaces to accommodate most press-fit sight profiles.

FITS ANY DOVETAIL SLOT DOWN TO 5/32" (4MM) WIDE

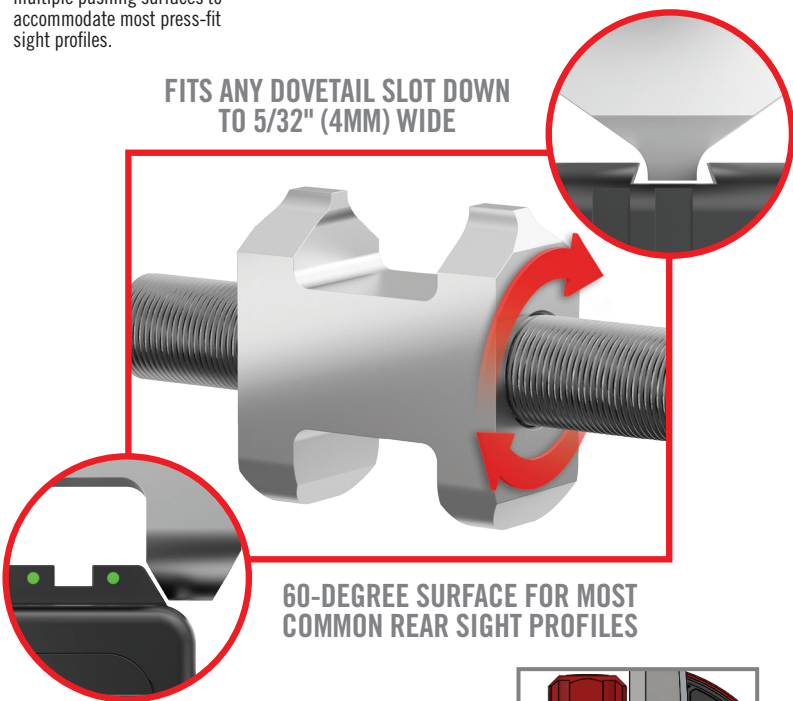

60-DEGREE SURFACE FOR MOST COMMON REAR SIGHT PROFILES

If you have a low-profile sight, or one with a small surface to push on, it is recommended to use the 4mm wide tooth side of the Reversible Press Block. This narrow tooth can reach down inside most dovetails. Align the Reversible Press Block as low as possible for maximum leverage.

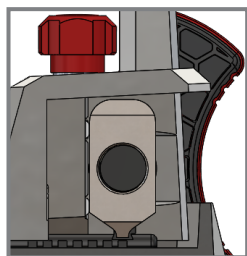

2 ALIGN FRONT SLIDE CLAMPS WITH CENTER OF DOVETAIL AND SECURE SLIDE IN SLIDE CRADLE.

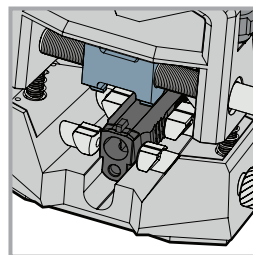

Loosen the Spring Loaded Vertical Adjustment Knobs to allow for height clearance and help with visibility. Be sure to check the Hold-Down Clamp, to make sure it is up all the way. Place pistol slide on Slide Cradle.

Center the slide and align front to back so the sight is directly under the press block. Tighten the four Side Clamp Adjustment Knobs to apply a light hold on the slide. This will allow precise position adjustments of the slide as you proceed.

Versatile Slide Cradle accommodates most makes and models of striker-fire and 1911 pistols.

MAKE SURE REVERSIBLE PRESS BLOCK IS CORRECTLY ALIGNED WITH DOVETAIL SLOT AND THAT THE SLIDE IS PARALLEL TO THE LINES RUNNING LENGTHWISE IN THE SLIDE CRADLE TO AVOID DAMAGING SLIDE

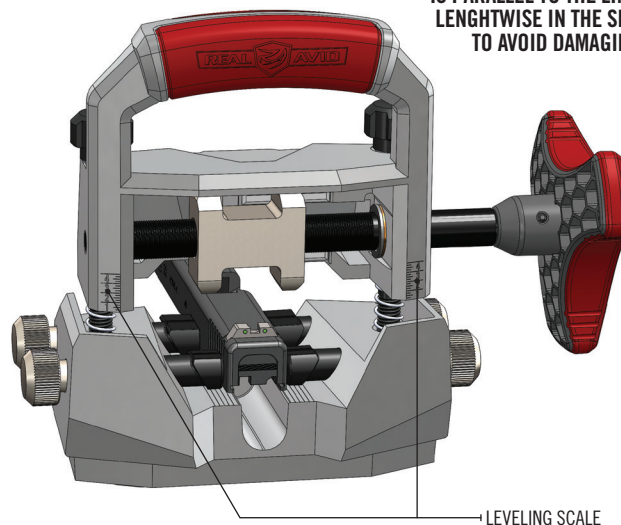

LEVELING SCALE

3 LOWER REVERSIBLE PRESS BLOCK TO THE APPROPRIATE HEIGHT.

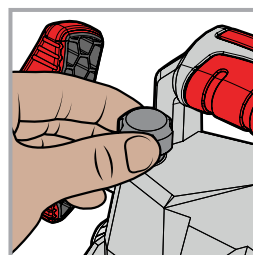

Use extreme caution when lowering the Reversible Press Block down to its optimum height. It is very easy to misalign features and cause damage to your gun's slide. Using a bright shop light and magnifying lens is highly recommended.

Lower the Upper Frame carefully into position by tightening the two Spring Loaded Vertical Adjustment Knobs simultaneously while monitoring leveling scale. The height of Reversible Press Block should be predetermined: above the top of slide, or inside the dovetail. During this process, you should make any final front-to-back adjustments to the clamped position of the slide and apply final tightening pressure to the Slide Clamp Adjustment Knobs.

Turn both Spring Loaded Vertical Adjustment Knobs simultaneously to avoid binding and keep Upper Frame level.

4

SNUGLY TIGHTEN HOLD DOWN CLAMP TO STABILIZE PISTOL SLIDE.

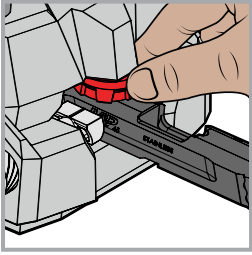

Once the Upper Frame is moved to the correct position, lower the Hold Down Clamp to the top surface of the slide to completely lock slide into place prior to pushing sight.

WARNING If over-tightened, Hold Down Clamp can damage surface finish on slide and bend Spring Loaded Vertical Adjustment Knobs

5

CONFIRM ALIGNMENT WITH REVERSIBLE PRESS BLOCK AND SIGHT.

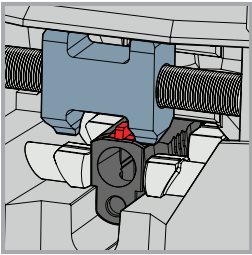

Use this step to ensure everything has remained aligned during the locking process and that the Reversible Press Block remains in correct alignment with the sight or dovetail slot. It must completely clear the slide to prevent damage.

Special Note: when utilizing the 4mm tooth surface to push within the dovetail slot, use extreme caution when lowering the Reversible Press Block down to final height. It is very easy to misalign features and cause damage to your gun's slide.

WARNING Failure to align slide properly will cause damage

6

TURN EASY TORQUE HANDLE™ AND PUSH SIGHT THROUGH DOVETAIL SLOT.

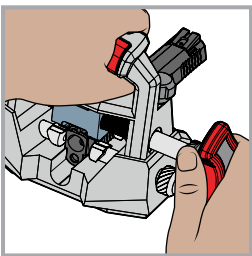

Turn Easy Torque Handle either clockwise or counterclockwise dependent on the direction you are pushing the sight (double check direction with slide manufacturer). Handle should turn easily and you should not feel any binding. If you perceive over-resistance re-check alignment and clearance prior to proceeding.

WARNING Do not exceed 150 in-lbs of torque

The oversized and comfortable Easy Torque Handle makes turning a breeze.

POWERFUL
TORQUE
CONTROL



CARE & MAINTENANCE

Store in a cool, dry location. Keep all threads and rotating interfaces oiled.

WARRANTY

LIMITED – 3 YEAR WARRANTY: Master Sight Pusher™ is guaranteed free of defects in materials and workmanship for three years from date of original purchase. Real Avid will replace or repair any product that proves defective upon our inspection. Use of the Master Sight Pusher for anything other than its intended purpose is considered misuse and voids this warranty. For warranty service, send the product, proof of purchase with shipping paid, along with an explanation of the defect, as well as your name, address and phone number to the address below. This warranty excludes damage resulting from deliberate or accidental misuse. Warranty does not cover rust, stains or corrosion, or normal wear and tear. Repair or replacement is the exclusive remedy under this warranty. Real Avid, its partners and affiliates are not liable for incidental or consequential damage resulting from use. Some states do not allow exclusion or limitation of incidental or consequential damages; therefore, the above exclusions may not apply to you. This warranty gives you specific legal rights, and you may have other rights, which vary from state to state.

WARNING: The Master Sight Pusher is designed to push sights up to a maximum torque of 150 inch-lbs. For this reason, do not use the Master Sight Pusher on sights that have been hydraulically pressed by the manufacturer (Springfield XD Series as an example), or any sight requiring more than 150 inch-lbs. of torque to remove. If you experience heavy resistance or binding, it is best to check torque with an inch-pound torque wrench inserted into the 3/8" receiver in the center of the Easy Torque Handle™. Do this to ensure the torque limit of the tool is still within the upper operating limit to avoid damage to slide or tool. Operating the tool beyond the 150 inch-lb limit is at your own risk, and not recommended.

As a convenience to you, we have provided additional slide clamps. These parts are purposefully manufactured from plastic to reduce the possibility of scratches to your slide. The high-strength resin is tough, but not indestructible from excessive forces. They are meant to fail before too much force is applied to the sight pusher or to your slide.

If you notice continual deformation of these slide clamps, consider improving the fit of new sights by filing their edges. Sights that have been factory installed with hydraulic presses are often damaged during the removal process and are best suited to be cut or hammered out. Following these guidelines and keeping the threaded drive and bearing surfaces well oiled will ensure years of trouble-free use.

DO NOT EXCEED 150 INCH-LBS OF TORQUE WHILE USING THE 3/8" DRIVE



MASTER SIGHT PUSHER®

PRECISION ENGINEERED SIGHT CHANGER

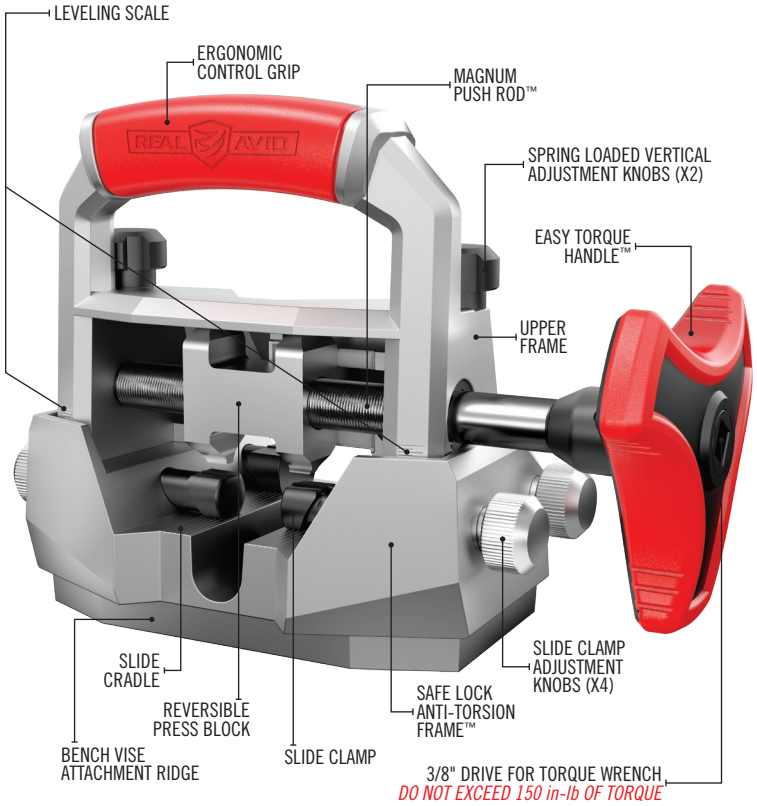

TO FRIENDS AND CUSTOMERS: As the owners of Real Avid®, authenticity isn't just a strategy here. It's a guiding philosophy. It arises out of our faith and personal relationships with Jesus Christ. We know that our creativity and success ultimately comes from Him. He cares about each of us and about our customers. We're not perfect, but we are committed to following Him in our personal and business lives.

We look forward to growing our relationship with you and continuing to earn our place.



5480 Nathan Lane North, Suite 120
Minneapolis, MN 55442 USA

RealAvid.com • 800-286-0567